

# IPCO FLASHING SYSTEM DETAILS

The IPCO FLASHING SYSTEM easily adapts to the most problematic of flashing conditions in masonry walls. The self-adhesive properties of IPCO Flashing creates a continuous moisture barrier to protect the structure.

## PREFORMED INSIDE CORNER

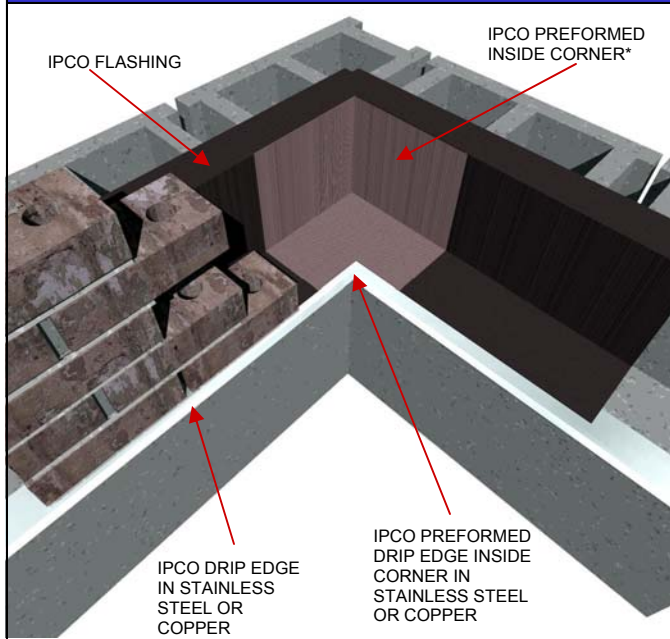

\*NOTE: The actual preformed inside corner is shown here on top of the flashing for clarity. Actual installation should be under the flashing membrane.

## PREFORMED OUTSIDE CORNER

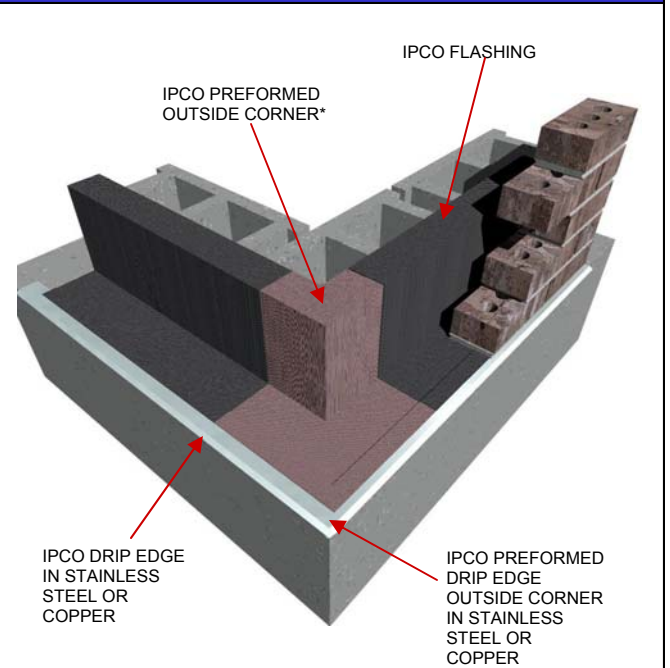

\*NOTE: The actual preformed outside corner is shown here on top of the flashing for clarity. Actual installation should be under the flashing membrane.

## SINGLE WYTHE CMU BASE FLASHING

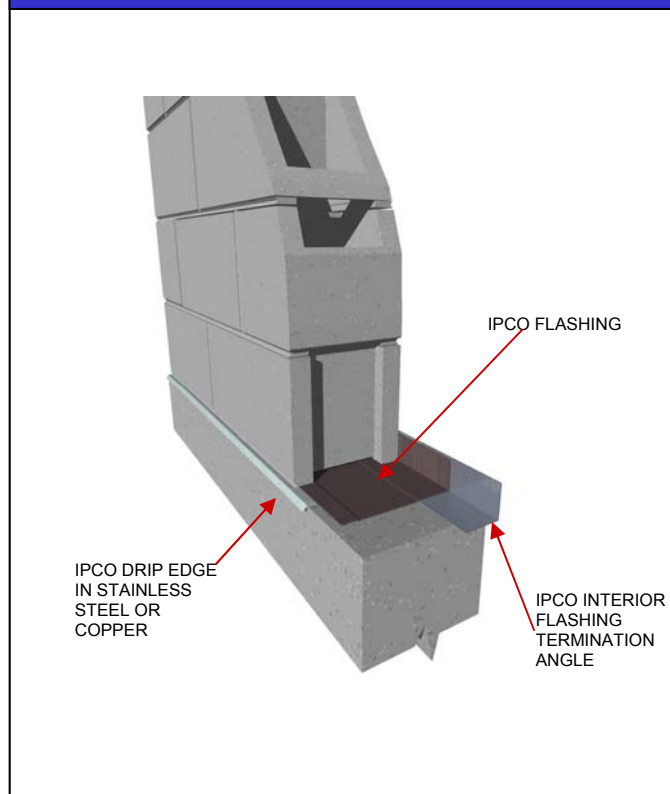

## SINGLE WYTHE CMU LINTEL FLASHING

